

**BRETTFORD®**  
 11000 SEYMOUR AVENUE FRANKLIN  
 PARK, ILLINOIS 60131 USA  
 (PHONE) 847-678-2545  
 (TOLL FREE FAX) 800-343-1779  
 (FAX) 847-678-0852  
 WWW.BRETTFORD.COM

**NORTH MS**  
**INFORMATION CENTER**  
**MEMOMONEE FALLS, WI 53051**

PROJECT NAME & LOCATION:  
 END USER SIGN-OFF & DATE:  
 BRETTFORD SALES MANAGER:  
**G. DALBKE**  
 BRETTFORD PROJECT DESIGNER:  
**R. DAVOLOS**

DATE & REVISION LEVEL:  
**12.11.13 (ORIG.)**

PROJECT NUMBER:  
**15122**

\* ALL DIMENSIONS REQUIRE FIELD  
 VERIFICATION. BRETTFORD  
 RECOMMENDS ALL CLEARANCES TO  
 BE A MINIMUM OF 36" WIDE \*

THIS DRAWING IS THE SOLE  
 PROPERTY OF BRETTFORD  
 MANUFACTURING, INC. AND MAY  
 NOT BE USED FOR COMPETITIVE  
 PRICING. © 2006 ALL RIGHTS  
 RESERVED.

LEGEND	
<b>B</b>	EDUS4R24C-01: 56"W x 24"D x 22-32"H EXPLORE 4-LEG QUARTER ROUND ACTIVITY TABLE WITH CASTERS & EDUSTC: EXPLORE ARMLESS CHAIR WITH CASTERS
<b>C</b>	EDUS4242C-01: 42"W x 42"D x 22-32"H EXPLORE 4-LEG SQUARE ACTIVITY TABLE WITH CASTERS & EDUSTC: EXPLORE ARMLESS CHAIR WITH CASTERS
<b>D</b>	EDUK4848SP-08: 48"W x 48"D x 39.5"H EXPLORE PEDESTAL BASE SQUARE CAFE TABLE WITH CUT-OUT FOR RDOME POWER UNIT, RDOME40: 4-OUTLET POWER DOME & EDUSTTG: EXPLORE ARMLESS STOOL WITH GLIDES
<b>E</b>	EDUSDPT60C-01: 60"W x 42"D x 22-32"H EXPLORE 4-LEG TEAMING TABLE WITH CASTERS AND POWER & EDUSTC: EXPLORE ARMLESS CHAIR WITH CASTERS
<b>F</b>	EDUMT2020-08: 20"W x 20"D x 16"H MOTIV SQUARE OCCASIONAL TABLE
<b>G</b>	EDUMT30D-08: 30"DIA x 16"H MOTIV CIRCLE OCCASIONAL TABLE
<b>H</b>	HMDE60C: 60"W x 73.25"H PORCELAIN MOBILE HERE BOARD
<b>I</b>	MDS-68: 47"W x 68"H LIQUID FABRIC PRIVACY SCREEN
<b>J</b>	EDUMS350: 32"W x 32"D x 34"H MOTIV ARM CHAIR
<b>K</b>	EDUMDB600: 58"W x 32"D x 17"H MOTIV MODULAR DOUBLE BENCH
<b>L</b>	EDUMS300: 23"W x 32"D x 34"H MOTIV ARMLESS CHAIR
<b>M</b>	EDUMDB400: 23"W x 32"D x 17"H MOTIV MODULAR SINGLE BENCH
ALL OTHER FURNITURE IS INCLUDED FOR SPACE PLANNING PURPOSES AND IS NOT INCLUDED IN THE QUOTE	

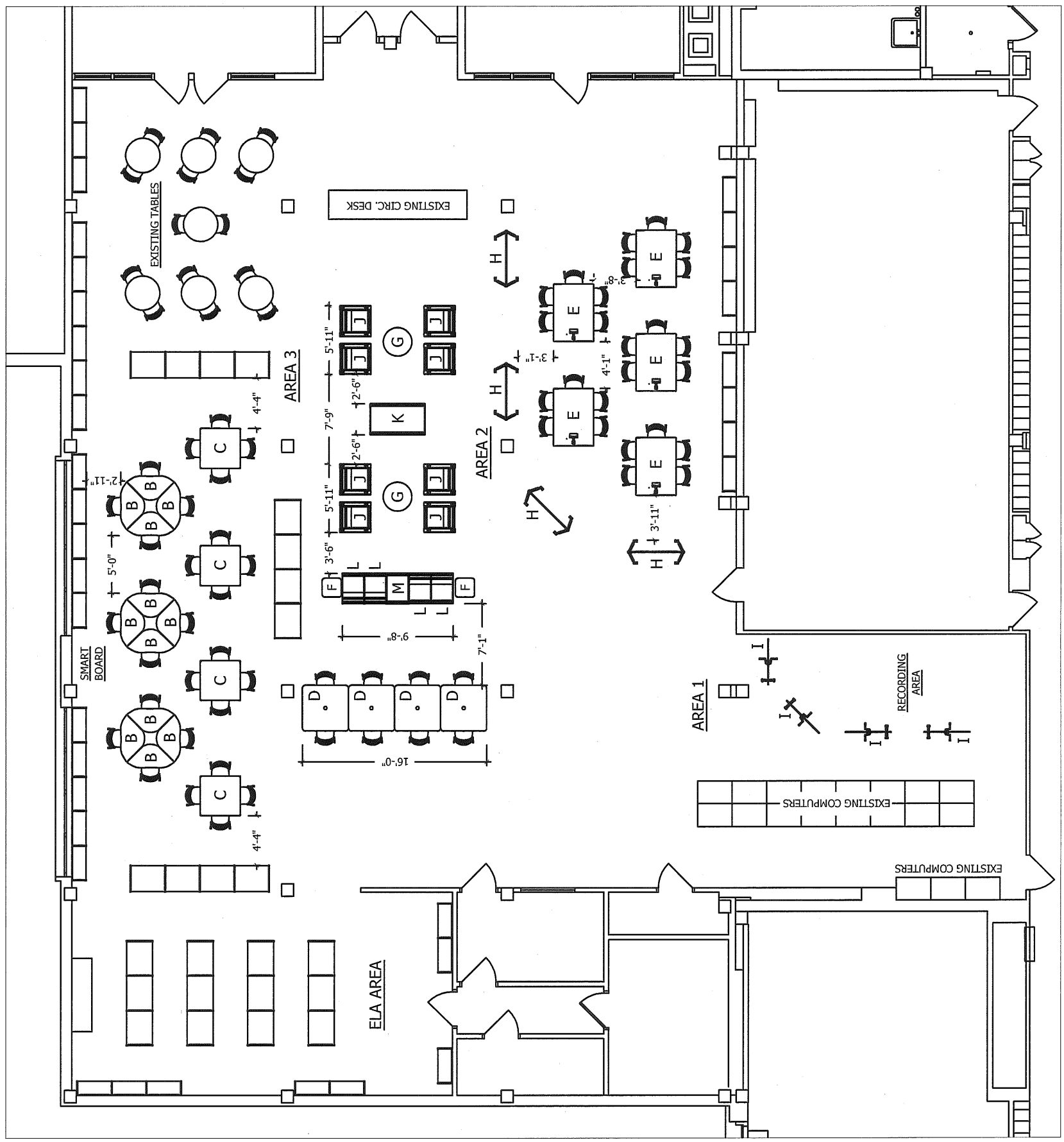

PLAN VIEW  
 SCALE: 3/32" = 1'-0"



**BRET FORD®**  
11000 SEYMOUR AVENUE FRANKLIN  
PARK, ILLINOIS 60131 USA  
(TOLL FREE PHONE) 800-521-9614  
(PHONE) 847-678-2545  
(TOLL FREE FAX) 800-343-1779  
(FAX) 847-678-9852  
WWW.BRET FORD.COM

PROJECT NAME & LOCATION:  
**NORTH MS  
INFORMATION CENTER  
MEMONONEE FALLS, WI 53051**

END USER SIGN-OFF & DATE:

BRET FORD SALES MANAGER:  
**G. DALBKE**

BRET FORD PROJECT DESIGNER:  
**R. DAVOLOS**

DATE & REVISION LEVEL:  
**12.11.13 (ORIG.)**

PROJECT NUMBER:  
**15122**

\* ALL DIMENSIONS REQUIRE FIELD  
VERIFICATION. BRET FORD  
RECOMMENDS ALL CLEARANCES TO  
BE A MINIMUM OF 36" WIDE \*

THIS DRAWING IS THE SOLE  
PROPERTY OF BRET FORD  
MANUFACTURING, INC. AND MAY  
NOT BE USED FOR COMPETITIVE  
PRICING. © 2006 ALL RIGHTS  
RESERVED.

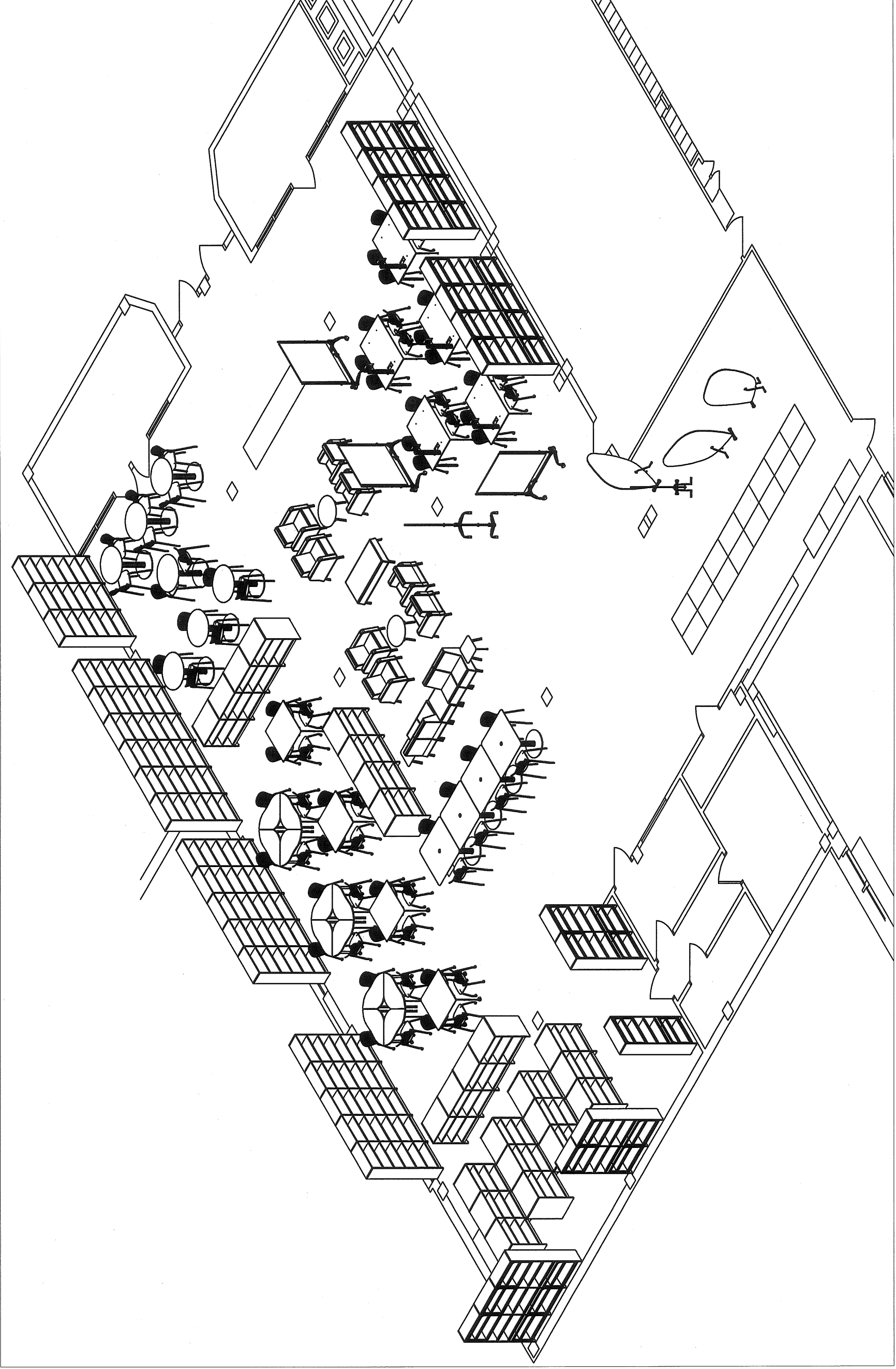

**PERSPECTIVE VIEW  
NOT TO SCALE**